

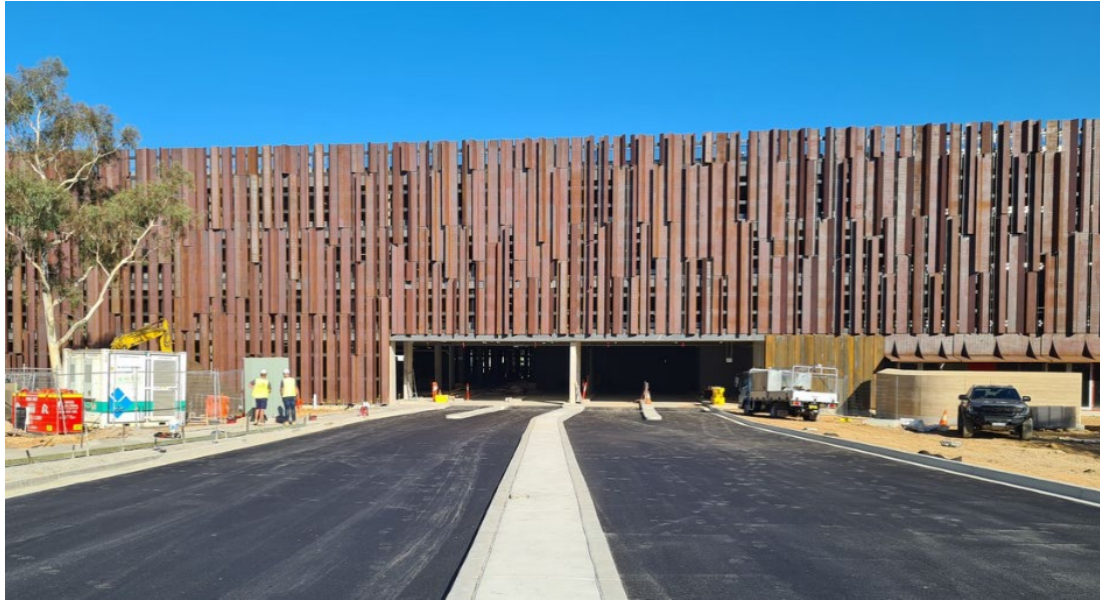

John Gorton Campus Car Park



The John Gorton Campus Car Park opens on Wednesday 12 February 2025 and provides over 1,000 car spaces in Parkes, ACT.

The John Gorton Campus Car Park is an enabling project for the development of the National Security Office Precinct (the Precinct) which will be located at the York Park Car Park, Barton ACT.

The development of the Precinct will result in the complete closure of the York Park Car Park from 12 February 2025. The John Gorton Campus Car Park will replace the loss of car parking spaces from York Park and provide parking for local workforce and visitors to the area.

Further landscaping works and other completion activities around the John Gorton Campus Car Park will continue throughout 2025. This will include precast concrete elements of the northern and southern facades to be installed later this year and are not required for the safe operation of the car park. Due to these works approximately 120 spaces across the car park will be offline until completion.

Parking costs

The John Gorton Campus Car Park is a public car park with pay parking arrangements to be managed by the National Capital Authority (NCA).

The NCA manages the pay parking arrangements in locations across Parkes, Barton, Russell and Acton on behalf of the Australian Government, including enforcement and breaches of parking regulations.

The cost of parking will align with all other NCA managed parking which is currently **\$17.00 per day** for long stay parking. Users are encouraged to check parking signage and refer to [NCA's website](#) for further details or changes to parking fees.

Location and entry

The John Gorton Campus Car Park is located adjacent to the John Gorton Building in Parkes, ACT and consists of the John Gorton Building East, multi-level (blue) and the John Gorton Building East, multi stay on-grade car park (pink). The John Gorton Building East, multi-level entry and exit are via the signalised intersection of Kings Avenue and Blackall Street.

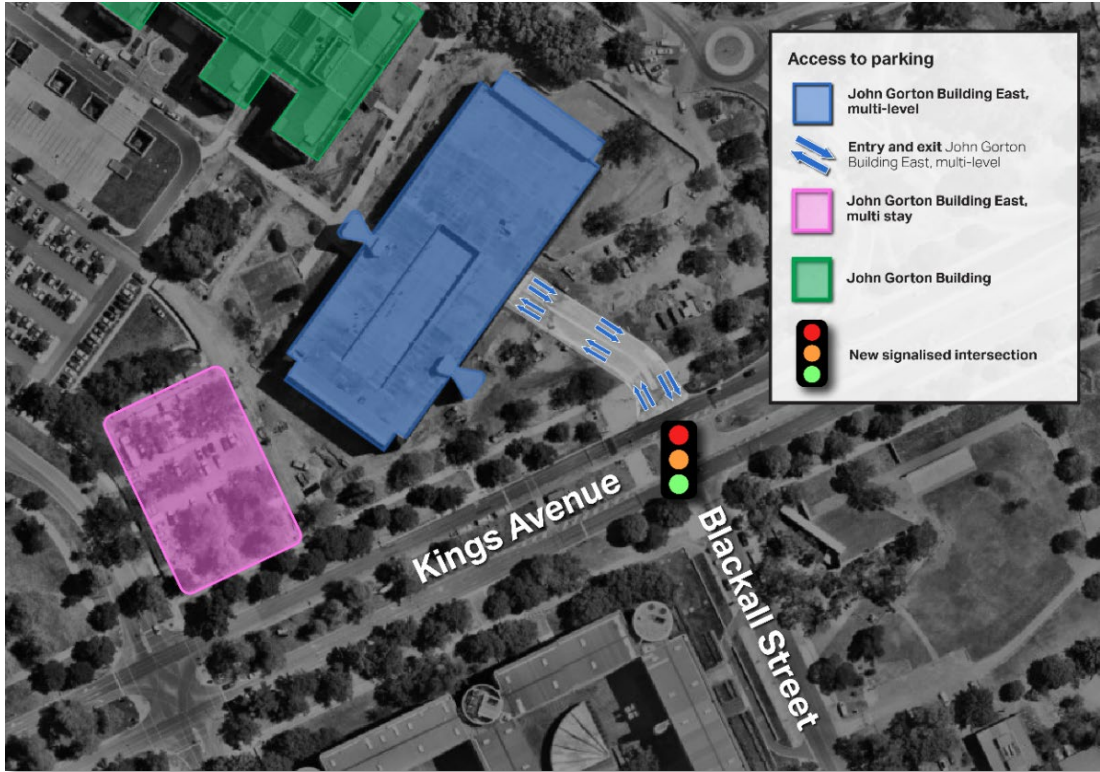

Aerial view of John Gorton Building East, multi-level (blue) and the John Gorton Building East, multi stay on-grade car park (pink).

Parking numbers

The below table outlines the location and number of parking spaces available to the public.

Location	Parking Spaces	Available from
John Gorton Building East, multi-level*		12 February 2025
Ground floor	<ul style="list-style-type: none"> Motorcycle 16 Accessible 11 EV 16 (<i>anticipated to be installed in early 2025</i>) 	
Level 1	Standard spaces 255 (<i>including 11 SES Class B Permit spaces</i>)	
Level 2	Standard spaces 255	
Level 3	Standard spaces 255	
Level 4	Standard spaces 218	
John Gorton Building East, multi stay		Early 2025
On-grade	<ul style="list-style-type: none"> Standard spaces ~73 Motorcycle 12 	

*Remaining ground floor spaces are for allocation to future childcare operator. Approximately 120 spaces across the John Gorton Building East, multi-level car park will be offline until completion of precast concrete elements.

Where to find more information?

For further information about the project:

- [Fact Sheet - Parking Options](#)
- [Fact Sheet - Travel and Transport Options](#)
- visit <https://www.finance.gov.au/nsop-project-updates>
- email NSOP.enquiries@finance.gov.au.